

P:\AE Projects\2017\17-35 FINAL ORTEGA\EDLEY'S BAR-B-QUE EXHIBIT 4-11-2018\17-35 SITE BASE FINAL ORTEGA REVISION 3.dwg
 Date: Apr 13, 2018 - 10:46am, By: lmalton

PROJECT CONTACTS:

OWNER

FIRST COAST ENERGY, LLC
 7014 AC SKINNER PKWY STE. 290
 JACKSONVILLE, FL 32256

DEVELOPER

EDLEY'S BAR-B-QUE
 2706 I2 AVE SOUTH
 NASHVILLE, TN 37204

ATTN: TODD OGLETREE
 TODDOGLETREE@EDLEYSBBQ.COM

VIRGINA OGLETREE
 VIRGINIAOGLETREE@YAHOO.COM

CIVIL ENGINEERS

ALMOND ENGINEERING, P.A.
 6277 DUPONT STA. COURT EAST, SUITE I
 JACKSONVILLE, FL 32217
 (904) 306-0162 PHONE

ATTN: MR. ERIC J. ALMOND, P.E.
 EALMOND@ALMONDENGINEERING.COM

ATTN: MRS. HILLARY L. ALMOND, P.E.
 HALMOND@ALMONDENGINEERING.COM

SURVEYOR

FIRST COAST LAND SURVEYING, INC.
 3161-4 ST. JOHNS BLUFF ROAD S.
 JACKSONVILLE, FL. 32246
 (904) 779-2062
 ATTN: CLYDE O. VAN KLEEK

LANDSCAPE ARCHITECT

JANET WHITMILL
 JANET O. WHITMILL, RLA, INC.
 PO BOX 5212
 JACKSONVILLE, FL. 32247-5212
 (904) 398-7688

EDLEY'S BAR-B-QUE

5344 ORTEGA BOULEVARD , JACKSONVILLE, FL 32210

RE # 102728-0000

GENERAL PROJECT INFORMATION

| | |
|----------------------------------|-------------|
| GENERAL | |
| City Development Number | IN PROGRESS |
| Concurrency Application Number | IN PROGRESS |
| Property Appraiser Number (RE #) | 102728-0000 |
| Zoning Designation | CN |
| PUD Ordinance Number | N/A |
| FIRM - Community - Panel | 12031C0364H |
| Flood Zones (Show in Plans) | ZONE X |
| Base Flood Elev. | 7' |
| Vertical Datum Used for Project | NAVD 88 |
| JEA Availability Number | IN PROGRESS |
| SJRWD Permit Number | IN PROGRESS |

| | |
|------------------------------------|-----|
| SUBDIVISION | |
| PSD Number | N/A |
| City or Private Inspection | N/A |
| Public or Private Roads | N/A |
| Subdivision ("911") Disk Provided? | N/A |

| | |
|---|------------|
| NON-SUBDIVISION | |
| North American Industry Classification System (NAICS) | 722511 |
| Impervious Area (Sq. Ft.) | 0000± S.F. |

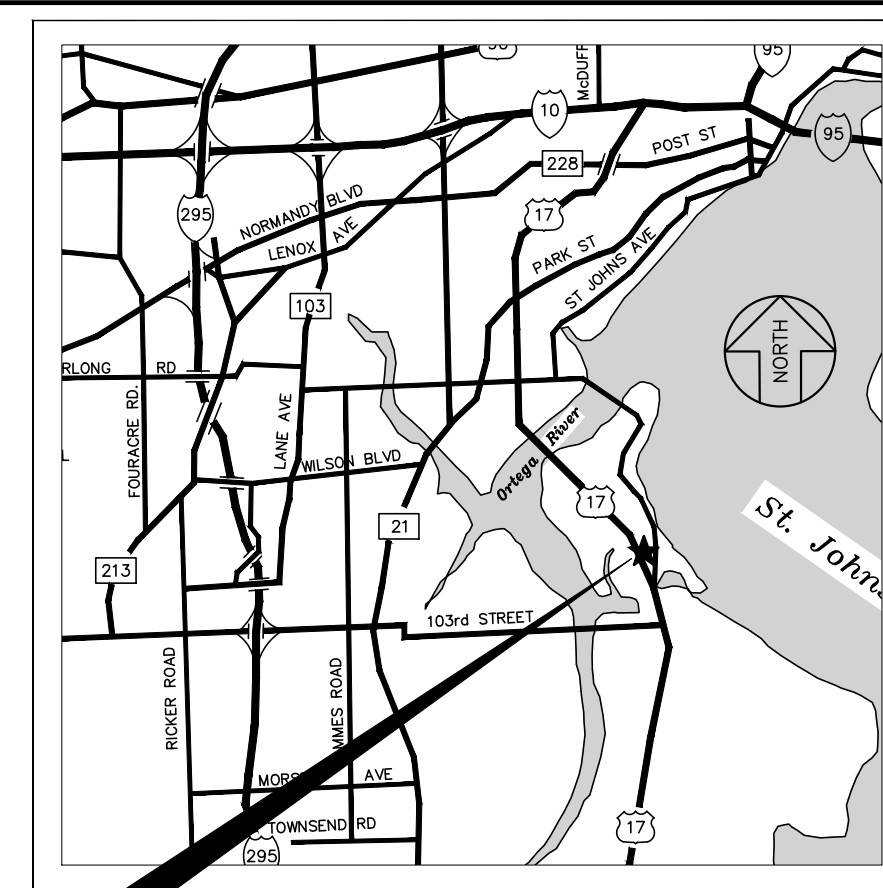
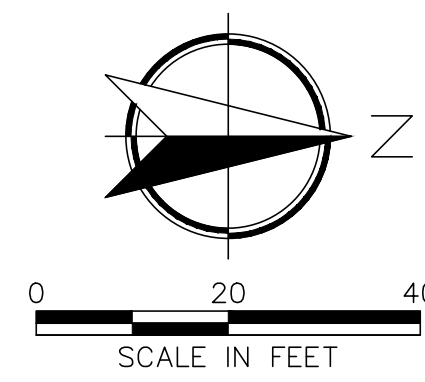

PROJECT LOCATION
 5344 ORTEGA BLVD
VICINITY MAP

| | |
|------|----------|
| Date | Revision |
| | |
| | |
| | |
| | |
| | |
| | |
| | |
| | |

AE JOB NO.: 17-35
 DESIGN: EJA
 DRAWN: LM
 CHECKED: EJA
 START DATE: 04-11-18
 PLOT DATE: 4-13-2018

**PRELIMINARY
 SITE PLAN**

EDLEY'S BAR-B-QUE, INC.
 5344 ORTEGA BOULEVARD
 JACKSONVILLE, FL 32210



**SHEET
 1**

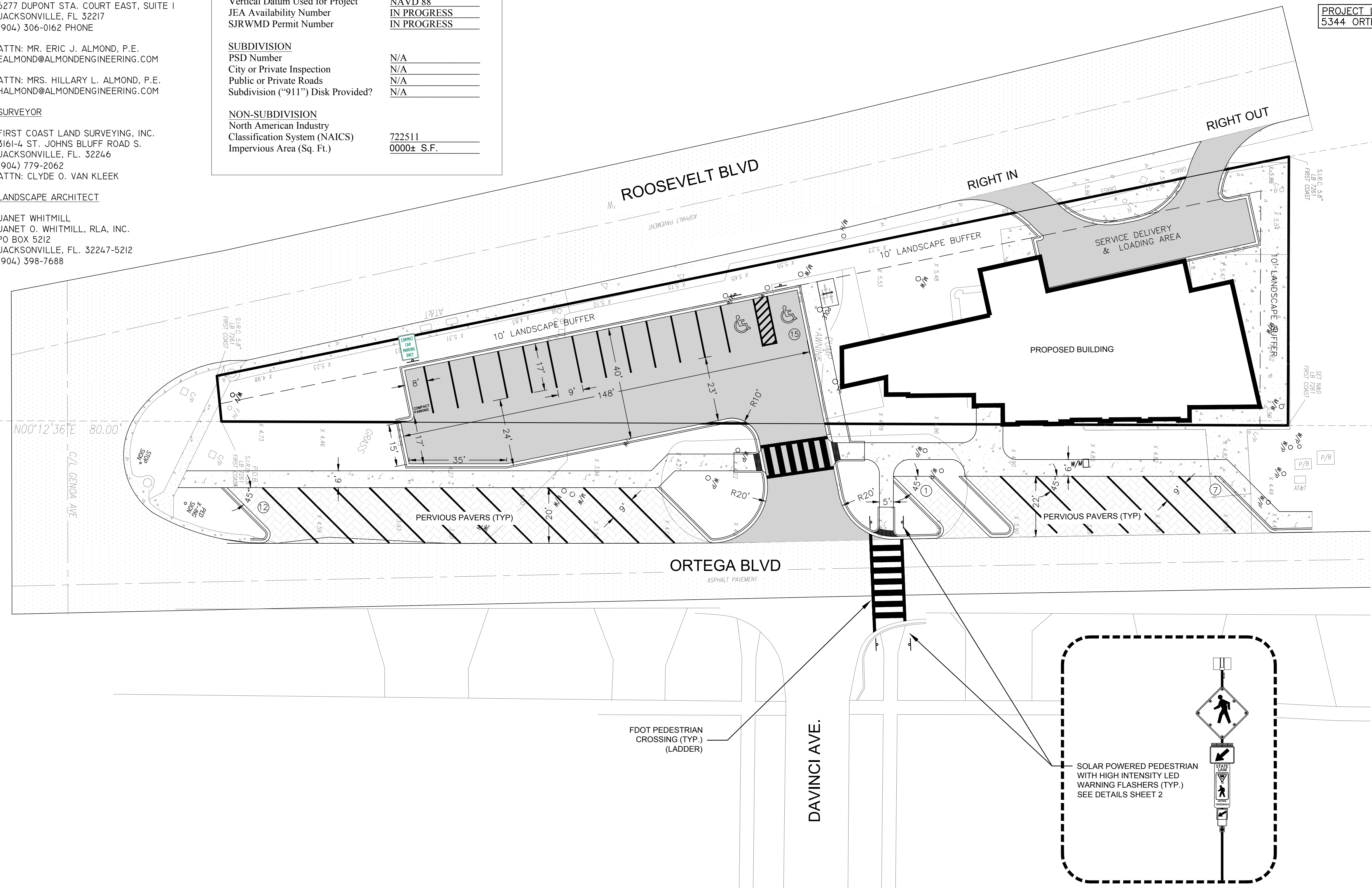

| SITE DATA SUMMARY | |
|--|-------------------------------|
| PROJECT SUMMARY: | |
| TOTAL SITE AREA: | 21,452± SF (0.49 Ac) |
| PROPOSED BUILDING AREA: | 5,800± SF (0.13 AC.) (26.53%) |
| NEW PVMT AREA: | 8,256± SF (0.18 Ac.) (38.48%) |
| CITY OF JACKSONVILLE MINIMUM PARKING REQUIREMENTS | |
| OFF STREET PARKING REQUIREMENTS: | |
| RESTAURANT: | |
| 1 SPACE PER 4 SEATS IN PUBLIC ROOMS PLUS | |
| 1 SPACE FOR EACH 2 EMPLOYEES | |
| 150 SEATS / 4 = 37.5 SPACES | |
| 20 EMPLOYEES / 2 = 10 SPACES | |
| SPACES REQ'D. | |
| MIN PARKING REQ'D : 48 SPACES | |
| PARKING PROVIDED : 35 SPACES | |
| HANDICAPPED PARKING REQUIREMENTS: | |
| * PER FLORIDA STATUTE 316.1955 & 316.1956 | |
| * PER A.D.A.A.G. s.4.1.2 (5) | |
| TOTAL PARKING | REQUIRED ACCESSIBLE SPACES |
| IN LOT | |
| 1-25 | 1 |
| 26-50 | 2 |
| 51-75 | 3 |
| 76-100 | 4 |
| 101-150 | 5 |
| 151-200 | 6 |
| PARKING REQ'D : 2 SPACE | |
| PARKING PROVIDED : 2 SPACE | |
| TOTAL OFF STREET VEHICLE PARKING: | |
| PARKING REQ'D : 48 SPACES | |
| PARKING PROVIDED : 35 SPACES | |

Plotfile: Apr 13, 2018 - 10:49am, By: lmalder

P:\AE Projects\2017\17-35 FINAL ORTEGA\EDLEY'S BAR-B-QUE EXHIBIT 4-11-2018\17-35 SITE BASE FINAL ORTEGA REVISION 3.dwg

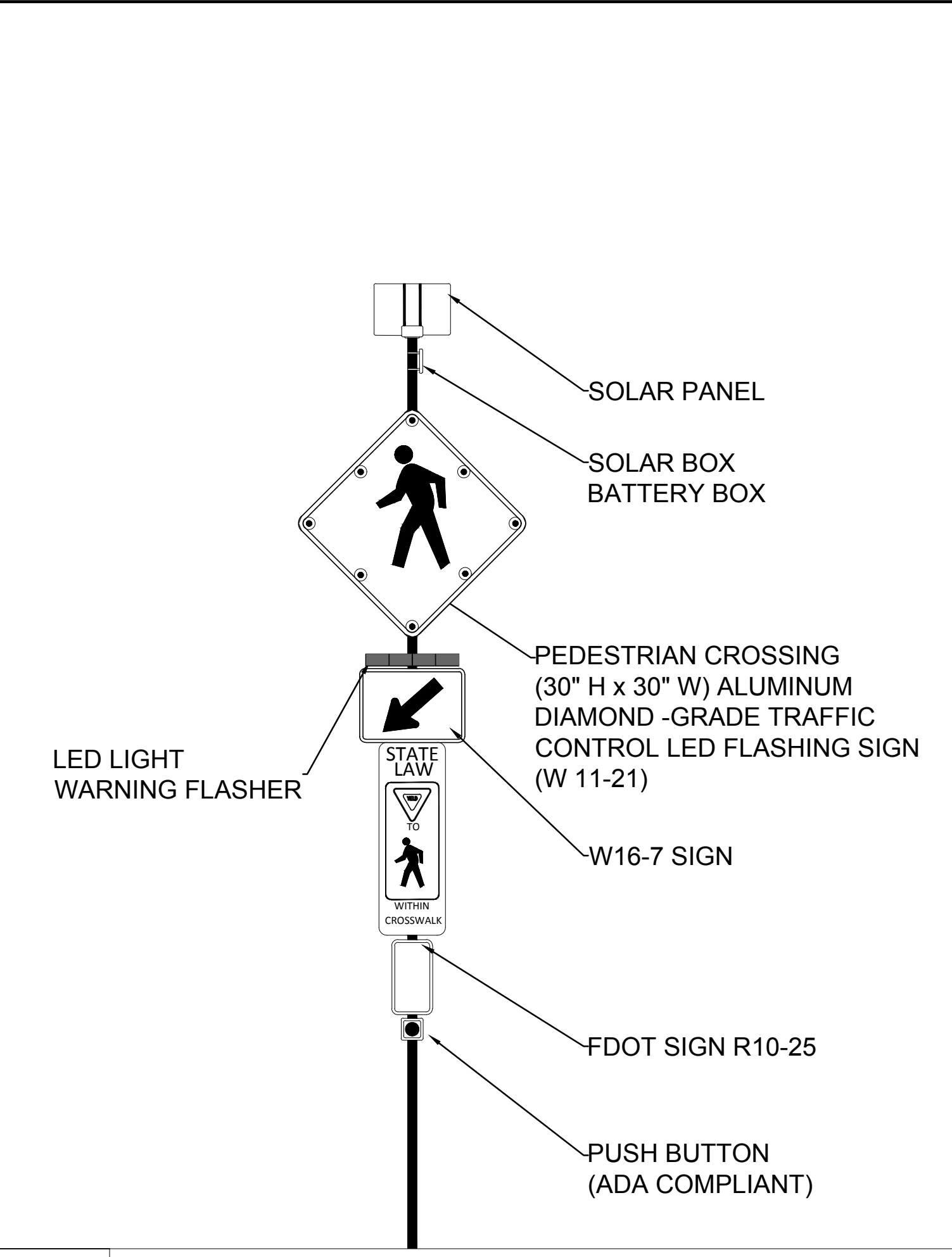
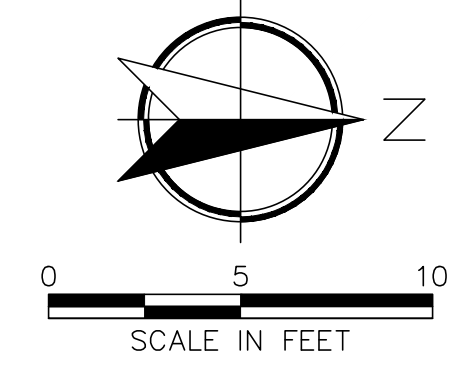
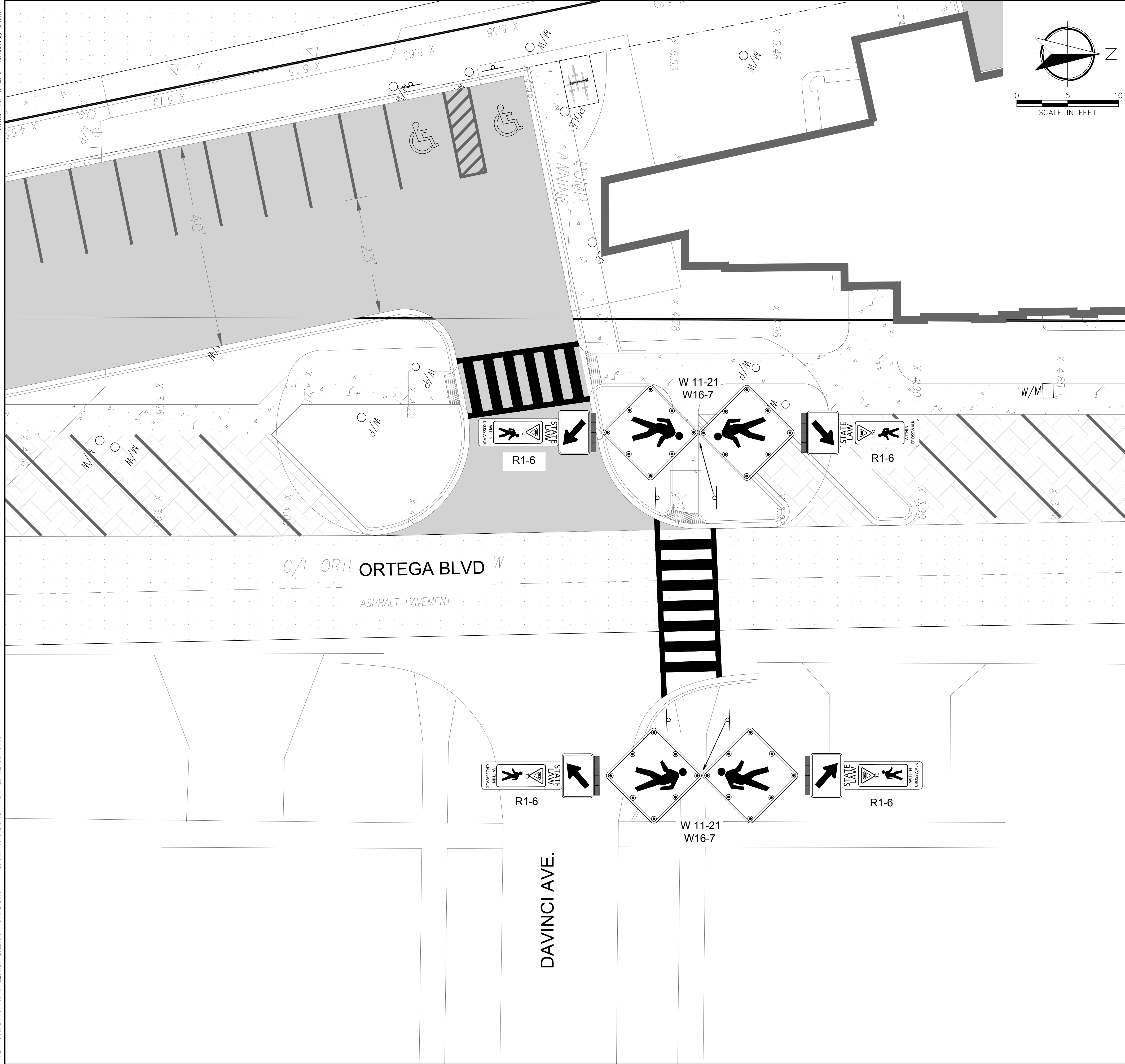

1 SOLAR POWERED PEDESTRIAN POLE DETAILS

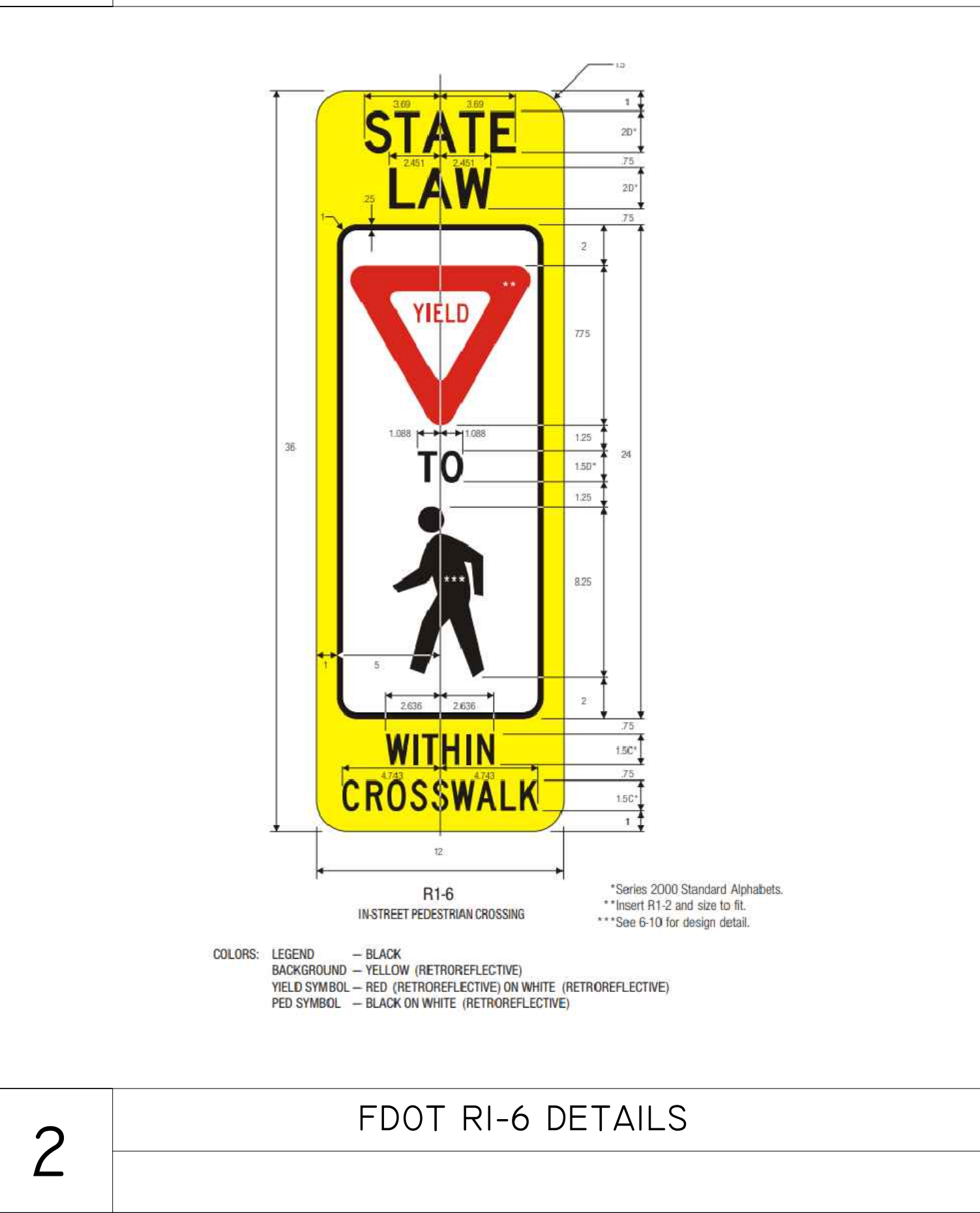

2 FDOT R1-6 DETAILS

| Date | Revision |
|------|----------|
| | |
| | |
| | |
| | |
| | |

AE JOB NO.: 17-35
 DESIGN: EJA
 DRAWN: LM
 CHECKED: EJA
 START DATE: 04-11-18
 PLOT DATE: 4-13-2018

PEDESTRIAN DETAILS

EDLEY'S BAR-B-QUE, INC.
 5344 ORTEGA BOULEVARD
 JACKSONVILLE, FL 32210

ALMOND
 ENGINEERING
 CONSULTING CIVIL ENGINEERS
 6277 DUPONT STATION COURT E., SUITE 1
 JACKSONVILLE, FL 32217
 (904) 306-0162 PHONE

SHEET
 2